

# rollyBox

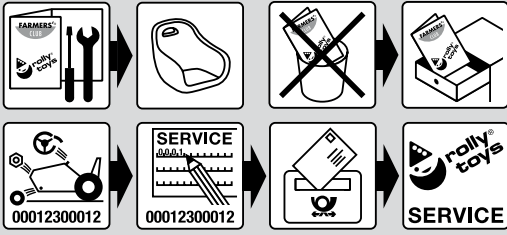
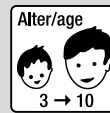

rolly toys Kundendienst Deutschland:

Tel: +49 (0) 95 68 / 856-142  
 Fax: +49 (0) 95 68 / 856-183  
 e-mail: service@rollytoys.de

2019/08

894.000.800.00

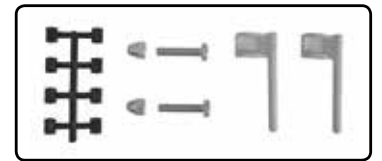
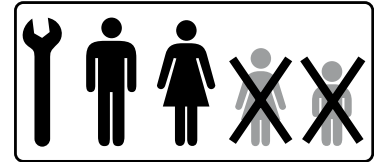
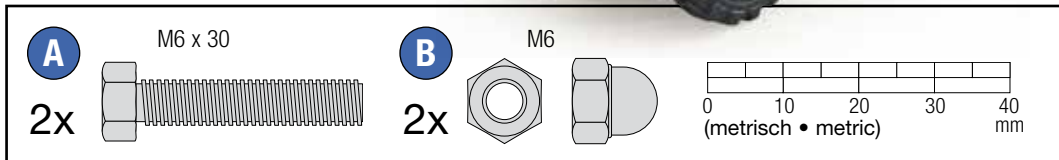
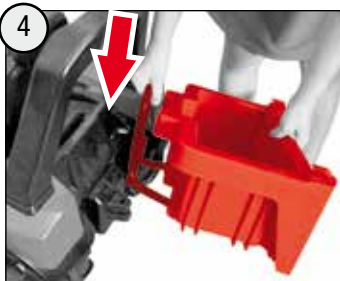
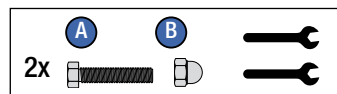
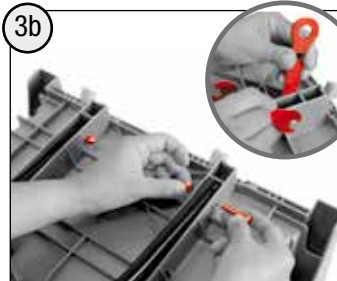
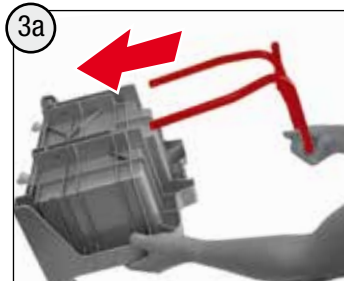
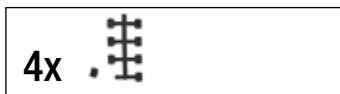
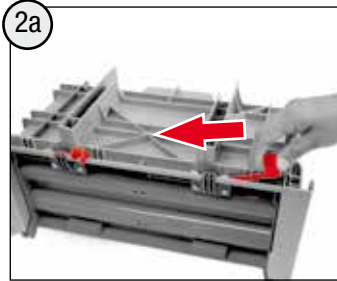
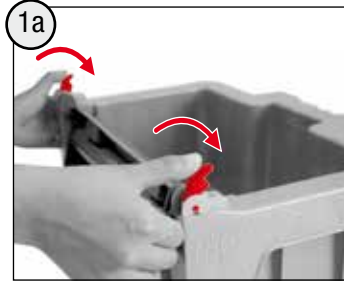
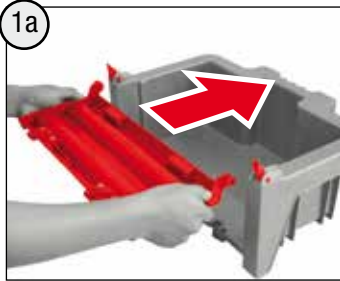

## WARNING

- CHOKING HAZARD - Small parts, Not for children under 3 years.
- Must be assembled by adults
- Adult supervision required.
- Toy is not suitable to carry children.
- If toy is defective stop using it, repairs may only be carried out by adults.
- Never use near steps, slopes, driveways, hills, roadways, alleys or swimming pool areas.
- Always wear shoes.
- Conforms to the requirements of ASTM Standard Consumer Safety Specification on Toy Safety, F 963.



**WARNING:**  
**CHOKING HAZARD – Small parts.**  
 Not for children under 3 years.



**Franz Schneider GmbH & Co KG**  
 P.O.Box 1460  
 D-96459 · Neustadt bei Coburg · Germany  
 Tel.: +49 (0) 95 68 / 856-0  
 Fax.: +49 (0) 95 68 / 856-190  
 www.rollytoys.com

---NORTH & SOUTH AMERICA only---  
**180 days warranty**  
 From the date of purchase + guaranteed spare part service  
 The warranty does not cover damages caused by improper use or neglect